

GA

Plan D

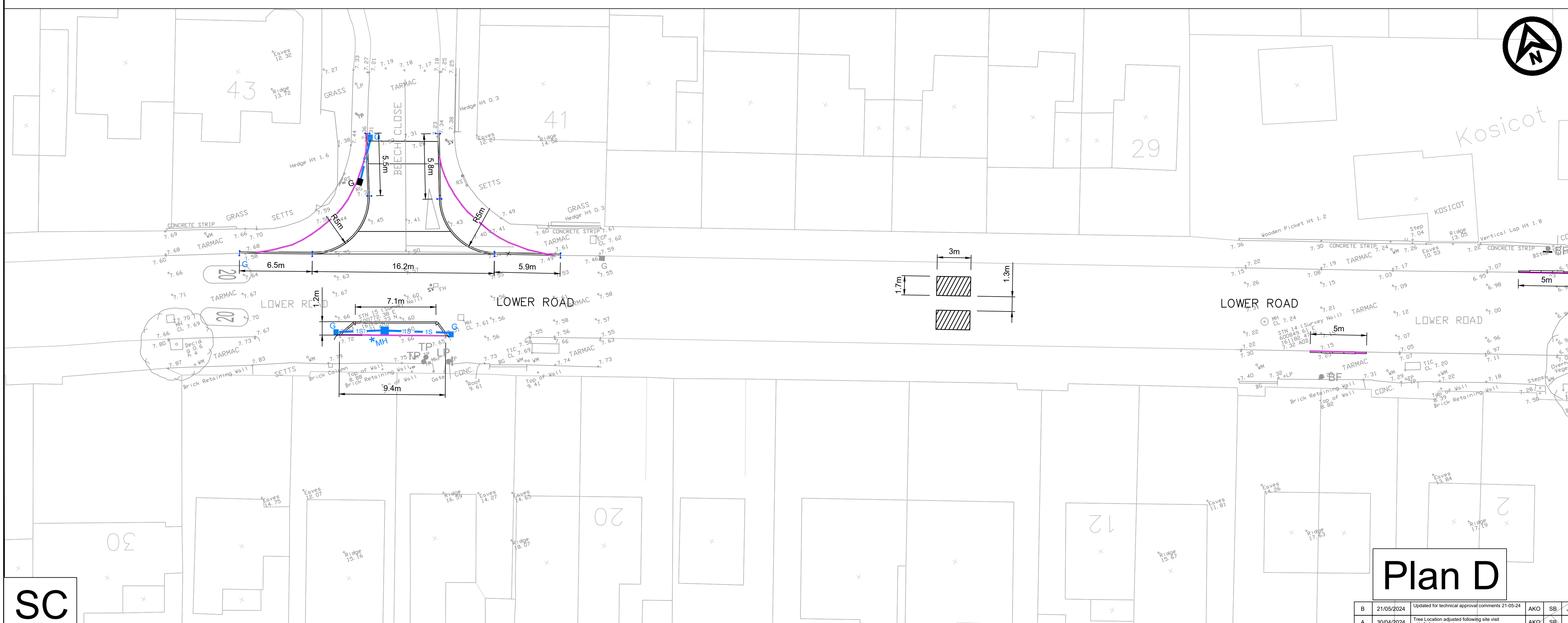

SC

Plan D

- Notes**
- Please see notes cover sheet which applies to all drawings
- Kerbing / Footway / Carriageway Construction Key**
- Overlay footway with AC3 dense surf 100/150 20mm thick over AC10 regulating layer. Perimeter of surface course to be keyed into existing surface course to give a minimum layer thickness of 20mm. All joints to be saw cut.
 - See design drawing for details
 - New grass seeding laid on a layer of top soil and Type 1 base. All joints to be saw cut
- HB2** Proposed 125 x 255mm half battered kerbing (Type HB2) "Haunch/Variation B" upstand 125mm to KCC1100/001/D
- DK** Proposed 125 x 150mm bullnose kerbing (Type BN). Upstand 0-8mm to KCC1100/001/D.
- TK** Proposed 125 x 150mm bullnose kerbing (Type BN). Upstand 25mm to KCC1100/001/D.
- D** Proposed 150 x 305mm half battered kerb (Type HB1) laid as dropper at bus boarder KCC1100/006.
- T** Proposed 125 x 150mm tapered kerb units (Type "DL" or CKL / CKR*) to KCC1100/001/D.
- Q3A** PCC quadrant kerb (Type QHB305).
- Buff PCC tactile paving 400 x 400mm. 50mm thick slabs, to KCC1100/015. Blisters to align with tactile on opposite side of road.
 - Buff PCC tactile paving 400 x 400mm. 50mm thick slabs, to KCC1100/015. Blisters to align with tactile on opposite side of road.
 - 50mm SMA 10 S5 surface course 40/60 WTR2.
 - 60mm SMA 14 60/20 WTR2.
 - 185mm AC32 HDM Base 40/60.
 - 165mm Type 1 Subbase 888AR
 - 50mm SMA10 surface course 40/60 WTR2 laid on, 60mm SMA 14 60/20 WTR2.
 - Reinstatement for carriageway: 50mm SMA10 surface course 40/60 WTR2
 - MMA "black colour" anti-skid material laid above existing surface.
 - New courtesy crossing feature using red, grey or buff surfacing (to be agreed on site with engineer). See details from KCC-HTW-1100-AT-1B
- 2 No. new Marshalls Reinforced Concrete speed cushions as per Technical Datasheet. Construction: AC32 subbase. Fast setting M60 based screed (with 1 day cure time before the surface course around the cushion is laid) and a AC10 surface course Approx. 135mm depth.
- Non-illuminated traffic sign (refer to Sign Schedule for details).
- Sign position and orientation (refer to Sign Schedule for details)
- New / Refreshed Road marking to TSRGD 2016 Diagram number.
- White Road marking.
- Yellow Road marking.
- Timber bollard with red / white bands (see Sign Schedule).

- Site Clearance Key**
- Remove and dispose of existing kerb including bedding and backing. * Disposed of at Contractor's licensed tip.
 - Remove road marking by hydroblasting
 - Take up existing blocks / pavers including sand/cement layer to store for reuse
 - Mill bituminous carriageway depth 100mm but not exceeding 125mm coal tar contaminated
 - Mill bituminous carriageway depth not exceeding 50mm
 - Break-out and dispose of existing concrete material
 - Excavate soft material to a depth of 100mm and tip
 - Backfilling disused gully internal diameter 400mm with in situ concrete ST2.
 - Bollard to be taken up and set aside for reuse
 - Tangent Point
 - Sign (and post) to be removed (refer to Sign Schedule).
- Drainage Key**
- MH Take up and adjust manhole cover to new level.
 - AM Take up and adjust medium service cover to new level.
 - AS Take up and adjust small service cover to new level.
 - AG Adjust existing gully grating and frame.
 - NG PCC trapped gully with class D400 grate as KCC/SD/500/009.
 - Connection of 150Ø pipe to new PCC chamber.
 - 1S 150Ø Twin wall pipe in Type S bed and surround.
 - MH New manhole chamber design group 1a (refer to KCC/SD/500/001 for details).
 - Existing road gully
- Street Lighting**
- New lamp column (see illuminated Sign Schedule).
 - New bellisha beacon (see illuminated Sign Schedule).
- Soft Landscaping**
- 12-14cm girth Field Maple Tree "Acer Campestre" and pit (see drawing details KCC-HTW-300-11). Pit volume 0.75 x 0.75 x 0.5m

Rev	Revision Date	Purpose of revision	AKO	SB	JW
0	31/01/2024	For Construction First Issue	AKO	SB	JW
1	21/05/2024	Updated for technical approval comments 21-05-24	AKO	SB	JW
2	30/04/2024	Tree Location adjusted following site visit with Soft Landscaping	AKO	SB	JW

Kent County Council
kent.gov.uk

Kent County Council
Ashford Highway Depot
Henwood Industrial Estate
Ashford
TN24 8AD
Tel: 03000 418181

Project: Active Travel
Faversham Cross Town Improvements

Drawing title: Design Drawing
Sheet 4

Drawing status: Detailed Design

Scale: 1:200 at A1 | Do not scale

Drawing number: 23-SW-AC-873-02 | Rev B